

## Product Overview & Type Number Structure

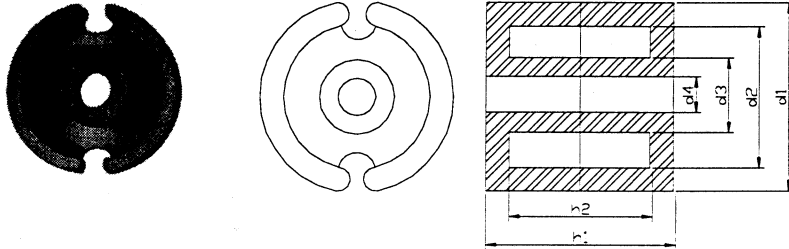

Product overview pot cores

CORE TYPE	Ve (mm <sup>3</sup> )	Ae (mm <sup>2</sup> )	MASS (g)
G9/5	120	10.0	4.0
G11/7	252	15.9	5.0
G14/8	500	25.0	6.0
G18/11	1120	43.0	10.0
G22/13	2000	63.0	16.0
G26/16	3460	93.0	24.0
G30/19	6100	136.0	40.0
G36/22	10600	202.0	70.0
G42/26	18285	265.0	110
G48/30	22620	312.0	70.0

Type number structure for cores

